

# MICHIGAN AIRPORT DEVELOPMENT PROGRAM

## AIP CAPITAL IMPROVEMENT PLAN 2010-2019

### FEDERAL/STATE/LOCAL



## Ann Arbor Municipal Airport

### Ann Arbor, MI

Date of Latest ALP - 2008  
ACIP Airport Code - A  
Airport Identifier - ARB



**MDOT-AERO**  
2700 E AIRPORT SERVICE DRIVE  
LANSING, MICHIGAN 48906

Prepared by: **URS Corporation**

Sponsor: City of Ann Arbor

Submitted by: Matt Kulhanek

Date: August 21, 2009

Revised: November 18, 2009

**MICHIGAN STATE BLOCK GRANT PROGRAM  
TEN-YEAR AIRPORT CAPITAL IMPROVEMENT PROGRAM (CIP) FY-2010\* to FY-2020**

\*ACIP includes current development year (2010 already programmed - minor changes acceptable)

Airport Name: <b>Ann Arbor Municipal Airport</b>										Date prepared: 11/18/2009	
Associated City: <b>Ann Arbor, MI</b>										Prepared By: URS Corporation	
Sponsor: <b>City of Ann Arbor</b>										Sponsor email address & phone: 734-994-2841 MJKulhanek@A2gov.org	
Airport Identifier: <b>ARB</b>										<b>FINAL ACIP due to MDOT AERO: no later than 12/1/09</b>	
Development Year	Project Description	Shown on ALP? (Yes or No)	ACIP Code**	NPIAS Priority Rating**	Federal Entitlements	Federal Apportionment	Federal Discretionary	State	Local	Total	Remarks/Item Justification - Provide as much detail as possible.
2010	<i>Available Entitlements</i>				\$ 150,000						
	Windcone, Signage and Taxiway Marking	NA	ST-OT-IN	43	\$ 48,450	\$ -		\$ 1,275	\$ 1,275	\$ 51,000	Existing signs and Windcone will be upgraded to use LED lights. Additional signage and marking to meet FAA requirements are provided.
	Exhibit A Property Map	NA	PL-PL-MA	68	\$ 38,000	\$ -		\$ 1,000	\$ 1,000	\$ 40,000	Airport needs to develop an Exhibit A property Map to comply with Federal Standards
	Reimburse for Lighting Improvements	NA	CA-RW-EX	56	\$ 22,800	\$ -		\$ 600	\$ -	\$ 23,400	Local paid work will be reimbursed. Airport replaced 40 LED MITL light fixtures. No labor was involved in this work. Airport will bid work to install Radio Control Equipment for the lighting system. No radio control currently exists. Local share is still shown for work in this year for other projects. This reimbursement will likely be used to cover the local share.
	Final Design Runway & Taxiway Extension	NA	CA-RW-EX	56	\$ 40,750	\$ 21,000		\$ 1,625	\$ 1,625	\$ 65,000	Provide for final design of Runway and Taxiway Extension.
2011	<i>Available Entitlements</i>				\$ 150,000						
	800' Runway & Taxiway Extension Construction	Yes	CA-RW-EX	56	\$ 150,000	\$ 1,048,900		\$ 31,550	\$ 31,550	\$ 1,262,000	Existing runway will be lengthened to 4300'. Runway will also be shifted 150' to the west to provide clearance over State Road on the East side of the airport. Parallel taxiway will be extended to match the new runway. Connector taxiway on the southeast side will be relocated to the new runway end. All taxiway lights will be replaced with LED fixtures.
					\$ -	\$ -				\$ -	
					\$ -	\$ -				\$ -	
2012	<i>Available Entitlements</i>				\$ 150,000						
	Carryover for Future Project	\$ -			\$ -	\$ -		\$ -	\$ -	\$ -	0
					\$ -	\$ -				\$ -	
					\$ -	\$ -				\$ -	
	<i>Carryover</i>				\$ 150,000						
2013	<i>Available Entitlements</i>				\$ 300,000						
	Terminal Parking Lot Expansion & Relocate Airport Drive Phase I	Yes	OT-OT-PA	23	\$ 236,550	\$ -		\$ 6,225	\$ 6,225	\$ 249,000	The current parking lot is too small for daily usage. Additional space passenger traffic requires increasing the parking lot size. (28 spaces). Airport Drive relocation is required to expand parking lot.
					\$ -	\$ -				\$ -	
					\$ -	\$ -				\$ -	
	<i>Carryover</i>				\$ 63,450						
2014	<i>Available Entitlements</i>				\$ 213,450						
	Rehabilitate Existing Airport Access Road	Yes	OT-GT-AC	23	\$ 213,450	\$ 106,700		\$ 8,425	\$ 8,425	\$ 337,000	Existing access road is over 20 years old and needs rehabilitation.
					\$ -	\$ -				\$ -	
					\$ -	\$ -				\$ -	
					\$ -	\$ -				\$ -	
2015	<i>Available Entitlements</i>				\$ 150,000						
	Carryover for Future Project	\$ -			\$ -	\$ -		\$ -	\$ -	\$ -	0
					\$ -	\$ -				\$ -	
					\$ -	\$ -				\$ -	
	<i>Carryover</i>				\$ 150,000						
2016	<i>Available Entitlements</i>				\$ 300,000						
	Terminal Building Expansion and Renovation	Yes	CA-TE-IM	44	\$ 295,450	\$ -		\$ 7,775	\$ 7,775	\$ 311,000	Existing terminal building is too small to meet current needs. Additional insulation will be added to existing building to conserve energy. Renovations will be necessary to meet current ADA and other codes.
					\$ -	\$ -				\$ -	
					\$ 4,550						
2017	<i>Available Entitlements</i>				\$ 154,550						
	SRE Equipment (Truck and Tractor)	NA	ST-EQ-SN	48	\$ 154,550	\$ 333,750		\$ 12,850	\$ 12,850	\$ 514,000	Existing equipment from city is aging and will need to be replaced. No FAA funding has been used for existing Snow Removal Equipment.
					\$ -	\$ -				\$ -	
					\$ -	\$ -				\$ -	
2018	<i>Available Entitlements</i>				\$ 150,000						
	Rehabilitate MIRL (Runway Edge Lights)	Yes	RE-RW-LI	72	\$ 130,150	\$ -		\$ 3,425	\$ 3,425	\$ 137,000	Replace all MIRL and guidance signs with new LED units. Project will reduce operating costs and downtime due to more efficient longer lasting bulbs.
	Reconstruct SE and NE Taxiways	Yes	RE-TW-IM	68	\$ 19,850	\$ 1,074,550		\$ 28,800	\$ 28,800	\$ 1,152,000	Pavements are aging and will need replacement. PCI was 80 and 82 for these pavements in 2005.
					\$ -	\$ -				\$ -	
	Rehabilitate and Expand Apron	Yes	RE-AP-IM	62	\$ 150,000	\$ 945,350		\$ 28,825	\$ 28,825	\$ 1,153,000	Apron pavement is aging and will need reconstruction. 5" concrete overlay will provide cost effective construction. There has been a steady growth in transient corporate flights into the airport along with the continual expansion of helicopter activity requiring increased aircraft parking. The airport is also experiencing a growth in tie-down activity in conjunction with an increased activity on football weekends and other similar community and University event days. The terminal aircraft parking apron is frequently full on many weekdays with large corporate aircraft and tie-down users. PCI in the Apron was 90 in 2005.
	Terminal Apron Lighting	Yes	ST-AP-LI	42	\$ -	\$ 103,550		\$ 2,725	\$ 2,725	\$ 109,000	Apron lights are old and require replacement. LED replacement lights will be installed.
					\$ -	\$ -				\$ -	
2020	<i>Available Entitlements</i>				\$ 150,000						
	Hangar Site Work	Yes	ST-PB-MS	40	\$ 121,600	\$ -		\$ 3,200	\$ 3,200	\$ 128,000	Currently, a detention pond is blocking development of additional corporate hangar space. Relocation of the pond will develop new corporate hangar space and apron. Pipe will need to tie into drainage system that outlets in pond to the northwest. Pavements will be crossed by pipe and will be restored.
	Rehabilitate Rwy and Txy Conc. Joint Seals and Remark	Yes	RE-RW-IM	72	\$ 28,400	\$ 47,600		\$ 2,000	\$ 2,000	\$ 80,000	Preventative maintenance on existing pavements. Repair failed concrete joints. Markings will be faded. Remark all existing markings.
					\$ -	\$ -				\$ -	

\*\*In accordance with FAA Order 5100.39A, Appendix 6 - Fields need to be completed

**Year 0 To Year 5  
Capital Improvement Plan  
2010-2019**

Prepared By: **URS Corporation**  
Location: **Ann Arbor Municipal Airport  
Ann Arbor, MI**

Projects			Funding	
	Estimated Cost	Description	Funds	Description
2010 Year 1	\$ 51,000	Windcone, Signage and Taxiway Marking	\$ (180,000)	2010 Project Total Cost from Left
	\$ 40,000	Exhibit A Property Map	\$ -	Non-Primary Entitlement Carryover
	\$ 24,000	Reimburse for Lighting Improvements	\$ 150,000	2010 Non-Primary Entitlement
	\$ 65,000	Final Design Runway & Taxiway Extension	\$ 21,000	Discetionary / State Aportionment
			\$ 4,500	State Match (2.5%)
			\$ 4,500	Local Match (2.5%)
				Unused Non-Primary Entitlement
	\$ 180,000	<b>Total</b>	\$ -	Balance
2011 Year 2	\$ 1,262,000	800' Runway & Taxiway Extension Construction	\$ (1,262,000)	2011 Project Total Cost from Left
			\$ -	Non-Primary Entitlement Carryover
			\$ 150,000	2011 Non-Primary Entitlement
			\$ 1,048,900	Discetionary / State Aportionment
			\$ 31,550	State Match (2.5%)
			\$ 31,550	Local Match (2.5%)
	\$ 1,262,000	<b>Total</b>	\$ -	Unused Non-Primary Entitlement
			\$ -	Balance
2012 Year 3	\$ -	Carryover for Future Project	\$ -	2012 Project Total Cost from Left
			\$ -	Non-Primary Entitlement Carryover
			\$ 150,000	2012 Non-Primary Entitlement
			\$ -	Discetionary / State Aportionment
			\$ -	State Match (2.5%)
			\$ -	Local Match (2.5%)
	\$ -	<b>Total</b>	\$ (150,000)	Unused Non-Primary Entitlement
			\$ -	Balance
2013 Year 4	\$ 249,000	Terminal Parking Lot Expansion & Relocate Airport Drive Phase I	\$ (249,000)	2013 Project Total Cost from Left
			\$ 150,000	Non-Primary Entitlement Carryover
			\$ 150,000	2013 Non-Primary Entitlement
			\$ -	Discetionary / State Aportionment
			\$ 6,225	State Match (2.5%)
			\$ 6,225	Local Match (2.5%)
	\$ 249,000	<b>Total</b>	\$ (63,450)	Unused Non-Primary Entitlement
			\$ -	Balance
2014 Year 5	\$ 337,000	Rehabilitate Existing Airport Access Road	\$ (337,000)	2014 Project Total Cost from Left
			\$ 63,450	Non-Primary Entitlement Carryover
			\$ 150,000	2014 Non-Primary Entitlement
			\$ 106,700	Discetionary / State Aportionment
			\$ 8,425	State Match (2.5%)
			\$ 8,425	Local Match (2.5%)
	\$ 337,000	<b>Total</b>	\$ -	Unused Non-Primary Entitlement
			\$ -	Balance

**YEAR 6 TO YEAR 10  
CAPITAL IMPROVEMENT PLAN  
2010-2019**

Prepared By: **URS Corporation**  
**LOCATION: Ann Arbor Municipal Airport**  
**Ann Arbor, MI**

PROJECTS		
	Estimated Cost	DESCRIPTION
2015  Year 6	\$ -	Carryover for Future Project
	\$ -	<b>TOTAL</b>

FUNDING	
FUNDS	DESCRIPTION
\$ -	2015 Project Total Cost from Left
\$ -	Non-Primary Entitlement Carryover
\$ 150,000	2015 Non-Primary Entitlement
\$ -	Discetionary / State Aportionment
\$ -	State Match (2.5%)
\$ -	Local Match (2.5%)
\$ (150,000)	Unused Non-Primary Entitlement
\$ -	Balance

2016  Year 7	\$ 311,000	Terminal Building Expansion and Renovation
	\$ 311,000	<b>TOTAL</b>

\$ (311,000)	2016 Project Total Cost from Left
\$ 150,000	Non-Primary Entitlement Carryover
\$ 150,000	2016 Non-Primary Entitlement
\$ -	Discetionary / State Aportionment
\$ 7,775	State Match (2.5%)
\$ 7,775	Local Match (2.5%)
\$ (4,550)	Unused Non-Primary Entitlement
\$ -	Balance

2017  Year 8	\$ 514,000	SRE Equipment (Truck and Tractor)
	\$ 514,000	<b>TOTAL</b>

\$ (514,000)	2017 Project Total Cost from Left
\$ 4,550	Non-Primary Entitlement Carryover
\$ 150,000	2017 Non-Primary Entitlement
\$ 333,750	Discetionary / State Aportionment
\$ 12,850	State Match (2.5%)
\$ 12,850	Local Match (2.5%)
\$ -	Unused Non-Primary Entitlement
\$ -	Balance

2018  Year 9	\$ 137,000	Rehabilitate MRL (Runway Edge Lights)
	\$ 1,152,000	Reconstruct SE and NE Taxiways
	\$ 1,289,000	<b>TOTAL</b>

\$ (1,289,000)	2018 Project Total Cost from Left
\$ -	Non-Primary Entitlement Carryover
\$ 150,000	2018 Non-Primary Entitlement
\$ 1,074,550	Discetionary / State Aportionment
\$ 32,225	State Match (2.5%)
\$ 32,225	Local Match (2.5%)
\$ -	Unused Non-Primary Entitlement
\$ -	Balance

2019  Year 10	\$ 1,153,000	Rehabilitate and Expand Apron
	\$ 109,000	Terminal Apron Lighting
	\$ 1,262,000	<b>TOTAL</b>

\$ (1,262,000)	2019 Project Total Cost from Left
\$ -	Non-Primary Entitlement Carryover
\$ 150,000	2019 Non-Primary Entitlement
\$ 1,048,900	Discetionary / State Aportionment
\$ 31,550	State Match (2.5%)
\$ 31,550	Local Match (2.5%)
\$ -	Unused Non-Primary Entitlement
\$ -	Balance

2020	\$ 128,000	Hangar Site Work
	\$ 80,000	Rehabilitate Rwy and Txy Conc. Joint Seals and Remark
	\$ 208,000	<b>TOTAL</b>

\$ (208,000)	2020 Project Total Cost from Left
\$ -	Non-Primary Entitlement Carryover
\$ 150,000	2020 Non-Primary Entitlement
\$ 47,600	Discetionary / State Aportionment
\$ 5,200	State Match (2.5%)
\$ 5,200	Local Match (2.5%)
\$ -	Unused Non-Primary Entitlement
\$ -	Balance









**Ann Arbor Municipal Airport**

YEAR (PROJECT NUMBER): 2011(1)

**DESCRIPTION: 800' Runway & Taxiway Extension Construction**

Work Item Description	Quantity	Unit	Price	Amount
Mobilization and Safety Security	1	Lump Sum	\$ 100,000.00	\$ 100,000
Pavement Removal	3,500	SYD	\$ 20.00	\$ 70,000
Runway Lighting	12	Each	\$ 950.00	\$ 11,400
Taxiway Lighting	20	Each	\$ 950.00	\$ 19,000
Relocate Existing Taxiway & Threshold Lights	11	Each	\$ 300.00	\$ 3,300
#8 Cable in Conduit	3,800	LFT	\$ 3.00	\$ 11,400
#6 Solid Counterpoise Wire	3,800	LFT	\$ 2.00	\$ 7,600
Replace Existing Txy Lights with LED Lamps	218	Each	\$ 550.00	\$ 119,900
Relocate Existing VASI	1	Each	\$ 10,000.00	\$ 10,000
Relocate REIL	2	Set	\$ 5,000.00	\$ 10,000
Relocate PAPI	1	set	\$ 10,000.00	\$ 10,000
Relocate ODAL'S	1	Lump Sum	\$ 15,000.00	\$ 15,000
Unclassified Excavation	40,000	CYD	\$ 4.00	\$ 160,000
Drainage	1	Lump Sum	\$ 40,000.00	\$ 40,000
6 Inch Aggregate Base Course	2,700	CYD	\$ 30.00	\$ 81,000
6 Inch Concrete Pavement	15,000	SYD	\$ 22.00	\$ 330,000
Runway Grooving	12,000	SYD	\$ 2.00	\$ 24,000
Turfing & Mulching	5	Acres	\$ 2,000.00	\$ 10,000
Marking	1	Lump Sum	\$ 50,000.00	\$ 50,000
Approach Markers	8	Each	\$ 350.00	\$ 2,800
Centerline monument	2	Each	\$ 1,000.00	\$ 2,000
				\$ -
				\$ -
				\$ -
				\$ -
				\$ -
				\$ -
				\$ -
				\$ -

TOTAL CONSTRUCTION		\$ 1,087,400.00
ENGINEERING FINAL DESIGN		
CONSTRUCTION ADMIN.		\$ 120,000.00
CONTINGENCY	5%	\$ 54,370.00
<b>TOTAL*</b>		<b>\$ 1,262,000.00</b>
TOTAL FEDERAL DOLLARS	95%	\$ 1,198,900
TOTAL STATE DOLLARS	2.5%	\$ 31,550
TOTAL LOCAL DOLLARS	2.5%	\$ 31,550

\* Amount rounded up to the nearest thousand dollars.

**DESCRIPTION AND JUSTIFICATION:**  
Existing runway will be lengthened to 4300'. Runway will also be shifted 150' to the west to provide clearance over State Road on the East side of the airport. Parallel taxiway will be extended to match the new runway. Connector taxiway on the southeast side will be relocated to the new runway end. All taxiway lights will be replaced with LED fixtures.

ALP STATUS	ENV.	PURPOSE:	Capacity	7
Yes	EA in previous year	COMPONENT:	Runway	10
		TYPE:	Extension/Expansion	6
		PRIORITY NUMBER		56

















**Ann Arbor Municipal Airport**

YEAR (PROJECT NUMBER): 2019(1)

DESCRIPTION: **Rehabilitate and Expand Apron**

Work Item Description	Quantity	Unit	Price	Amount
<b>Rehab</b>				
Mobilization	1	Lump Sum	\$ 15,000.00	\$ 15,000
Safety & Security	1	Lump Sum	\$ 5,000.00	\$ 5,000
Mill Existing Pavement	21,000	SYD	\$ 2.00	\$ 42,000
5" Concrete Overlay	21,000	SYD	\$ 25.00	\$ 525,000
<b>Expansion</b>				
Unclassified Excavation	3,200	CYD.	\$ 4.00	\$ 12,800
Aggregate Base Course 6"	1,500	CYD.	\$ 30.00	\$ 45,000
Bituminous Surface 3"	1,700	Tons	\$ 95.00	\$ 161,500
Trenching	800	LFT.	\$ 1.00	\$ 800
Underground Cable, 1/C #8	2,400	LFT.	\$ 2.00	\$ 4,800
Counterpoise Wire, #6	800	LFT.	\$ 3.00	\$ 2,400
Galvanized Steel Conduit, 2" Direct Burial	100	LFT.	\$ 35.00	\$ 3,500
Apron Lights	6	Each	\$ 9,000.00	\$ 54,000
Markings (Center & Edge)	1,200	SFT.	\$ 0.50	\$ 600
Seeding & Mulching	2	Acres	\$ 2,000.00	\$ 3,700
Tie-Downs	60	Each	\$ 600.00	\$ 36,000
				\$ -
				\$ -
				\$ -
				\$ -
				\$ -
				\$ -
				\$ -
				\$ -
				\$ -
				\$ -

TOTAL CONSTRUCTION		\$	912,100.00
ENGINEERING DESIGN		\$	100,000.00
CONSTRUCTION ADMIN.		\$	95,000.00
CONTINGENCY	5%	\$	45,605.00
<b>TOTAL*</b>		<b>\$</b>	<b>1,153,000.00</b>

TOTAL FEDERAL DOLLARS	95%	\$	1,095,350
TOTAL STATE DOLLARS	2.5%	\$	28,825
TOTAL LOCAL DOLLARS	2.5%	\$	28,825

\* Amount rounded up to the nearest thousand dollars.

**DESCRIPTION AND JUSTIFICATION:**

Apron pavement is aging and will need reconstruction. 5" concrete overlay will provide cost effective construction. There has been a steady growth in transient corporate flights into the airport along with the continual expansion of helicopter activity requiring increased aircraft parking. The airport is also experiencing a growth in tie-down activity in conjunction with an increased activity on football weekends and other similar community and University event days. The terminal aircraft parking apron is frequently full on many weekdays with large corporate aircraft and tie-down users. PCI in the Apron was 90 in 2005.

ALP STATUS	ENV.	PURPOSE:	Reconstruction	8
Yes	Categorical Ex. Expected	COMPONENT:	Apron	5
		TYPE:	Improvements	8
		PRIORITY NUMBER		62











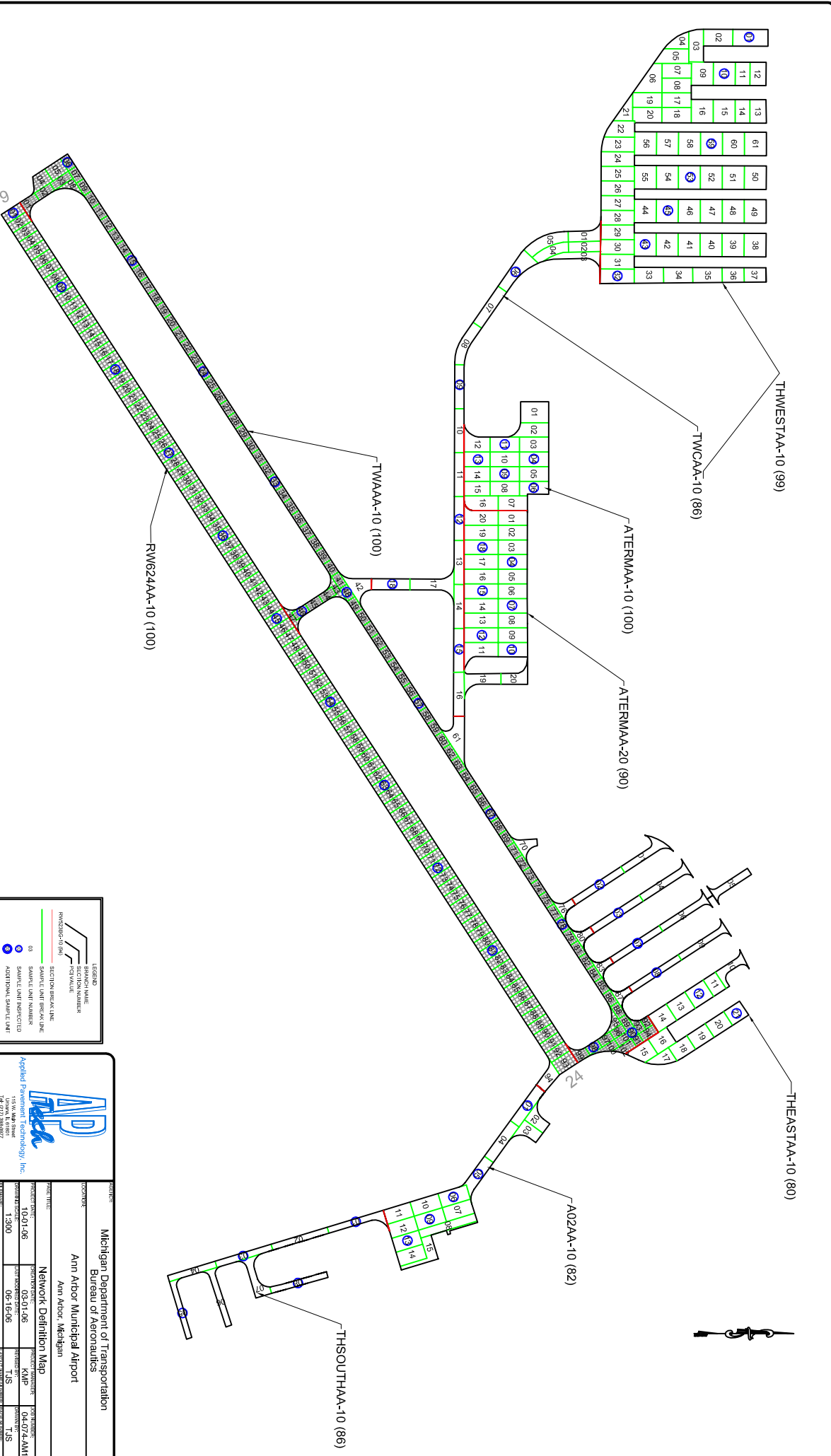

**LEGEND**

	BRANCH NAME
	SECTION NUMBER
	SAMPLE UNIT NUMBER
	SAMPLE UNIT INSPECTED
	ADDITIONAL SAMPLE UNIT



Michigan Department of Transportation Bureau of Materials Ann Arbor, Michigan	
PROJECT TITLE:	Network Definition Map
PROJECT NUMBER:	00-01-06
CONTRACT NUMBER:	05-01-06
DATE:	06-16-06
PROJECT MANAGER:	TJS
DESIGNER:	TJS
DATE:	04-07-04 AM
SCALE:	AS SHOWN
FIGURE:	Figure 3

BUILDING ELEVATION TABLE		
NO.	DESCRIPTION	ELEVATION
1	ADMINISTRATION/TERMINAL BUILDING	849.56
2	AIR TRAFFIC CONTROL TOWER (ATCT)	893.29
3	AIR TRAFFIC ADMINISTRATION BUILDING	864.52
4	CORPORATE HANGAR (AV. GAS CO.)	866.72
5	T-HANGAR	858.03
6	T-HANGAR	857.98
7	T-HANGAR	857.12
8	T-HANGAR	857.95
9	T-HANGAR	856.01
10	T-HANGAR (NESTED)	863.58
11	T-HANGAR (NESTED)	863.56
12	BARN	894.80
13	CORPORATE HANGAR (MICHIGAN UNIVERSITY)	861.57
14	FIXED BASE OPERATION HANGAR	862.57
15	T-HANGAR	846.73
16	T-HANGAR	846.47
17	T-HANGAR	843.65
18	T-HANGAR	846.30
19	T-HANGAR (NESTED)	849.13
20	ROTATING FLOOR HANGAR	850.89
21	CONVENTIONAL HANGAR	851.15
22	CONVENTIONAL HANGAR	847.51
23	CONVENTIONAL HANGAR	836.92
24	CONVENTIONAL HANGAR	836.87
25	FIXED BASE OPERATION HANGAR	846.03
26	OFFICE BUILDING	837.91
27	CITY WATER FACILITY	823.35
28	T-HANGAR	836.39
29	CONVENTIONAL HANGAR	842.77
30	T-HANGAR	834.98
31	T-HANGAR	835.85
32	T-HANGAR	836.80
33	CONVENTIONAL HANGAR	843.80
34	CONVENTIONAL HANGAR	842.34
35	CONVENTIONAL HANGAR	841.81
36	CITY WATER FACILITY	837.20
37	CITY WATER FACILITY	837.60
38	CITY WATER FACILITY	834.09
39	CITY WATER FACILITY	836.12

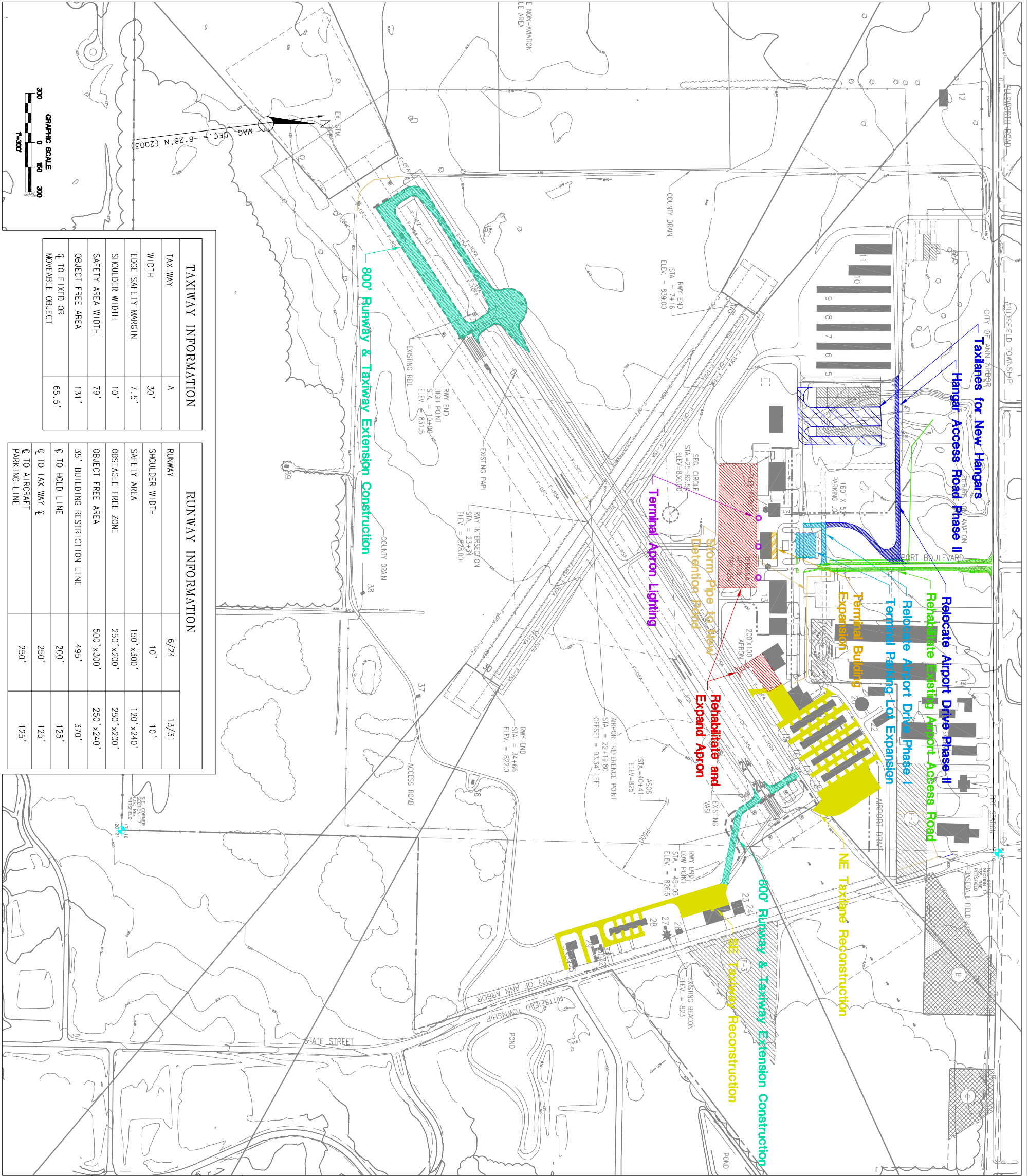

TAXIWAY INFORMATION	
TAXIWAY	A
WIDTH	30'
EDGE SAFETY MARGIN	7.5'
SHOULDER WIDTH	10'
SAFETY AREA WIDTH	79'
OBJECT FREE AREA	131'
Q TO FIXED OR MOVEABLE OBJECT	65.5'

RUNWAY INFORMATION		
RUNWAY	6/24	13/31
SHOULDER WIDTH	10'	10'
SAFETY AREA	150' x 300'	120' x 240'
OBSTACLE FREE ZONE	250' x 200'	250' x 200'
OBJECT FREE AREA	500' x 300'	250' x 240'
35' BUILDING RESTRICTION LINE	495'	370'
Q TO HOLD LINE	200'	125'
Q TO TAXIWAY	250'	125'
Q TO AIRCRAFT PARKING LINE	250'	125'

# ANN ARBOR MUNICIPAL AIRPORT

AIRPORT LAYOUT PLAN  
5 YEAR PLAN

ANN ARBOR, MICHIGAN

3950 SPARKS DR. S.E.  
616 574-8500

JW	X
RJC	X
DR	X
WMM	X
W. MALINOWSKI	

06/27/08 ALP PUBLICATION  
03/21/08 FAA AIRSPACE REVIEW  
12/17/07 MDOT DRAFT REVIEW

12940723
1
SITE NO. 81-1